

1 Millicent Oliver Close - Guide Price £325,000

Thetford IP24 1UP

chilterns

Estate & Letting Agents



"Consistently providing outstanding service to our clients"

Guide Price £325,000

The Property

This property on Millicent Oliver Close is set within an established residential area on the Ladies Estate in Thetford. With three generously sized double bedrooms, this property is perfect for families or those seeking single storey living. The larger than average lounge is bathed in natural light, creating a warm and inviting atmosphere throughout the home. The detached bungalow boasts ample driveway parking, accommodating up to three vehicles and single garage.

One of the standout features of this property is that it is being offered for sale with no onward chain, allowing for a smooth and hassle-free purchase process. Whether you are a first time buyer or looking to downsize, this bungalow presents an excellent opportunity to secure a comfortable and spacious home in a pleasant cul-de-sac position. With its generous size of accommodation, this bungalow is not to be missed.

AGENTS NOTE

Please be aware that images of the property may have been digitally enhanced, edited, or staged using artificial intelligence, and may not reflect the current presentation or furnishings.

Features

- POPULAR LADIES ESTATE DEVELOPMENT
- WITHIN EASY REACH OF A11
- WALKING DISTANCE TO THETFORD ACADEMY & DRAKE PRIMARY SCHOOL
- PLEASANT CUL-DE-SAC POSITION
- DETACHED BUNGALOW
- SINGLE STOREY LIVING
- SPACIOUS LOUNGE
- FULLY ENCLOSED REAR GARDEN
- NO ONWARD CHAIN
- VIEWING ADVISED!





These sales particulars have been produced as a general guide only and we would draw to your attention that we have not carried out a detailed Survey of the property nor have we tested services, appliances or specific fittings. Whilst measurements and statements given within the details are provided in good faith, their accuracy should not be relied upon. If there are any points about which you may be uncertain or would like further clarification, we would suggest that you telephone this office and speak to our staff who will endeavour to assist you.

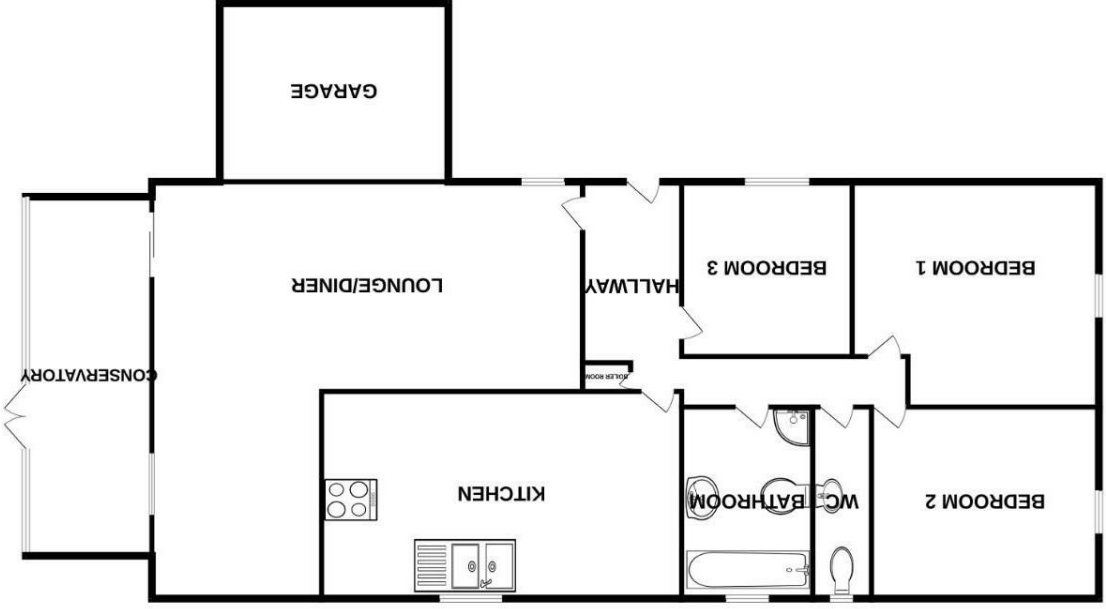

BUNGALOW

Whilst every attempt has been made to ensure the accuracy of the floorplan contained here, measurements of doors, windows, rooms and other items are approximate and no responsibility is taken for any omission or mis-statement. This plan is for illustrative purposes only and should be used as such by any prospective purchaser. The services, systems and appliances shown have not been tested and no guarantee as to their operability or efficiency can be given.
Made with floorplan ©2025

